

KETTLER Telescopic System

KIT

with coupling modules

Tools required:
Hammer
KIT dismantling tool
(for disassembling
spring connection
pieces if necessary)

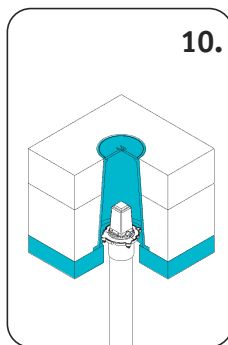
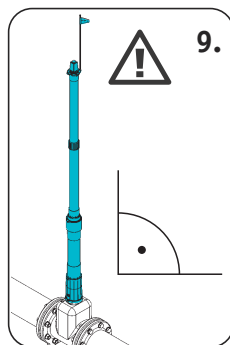
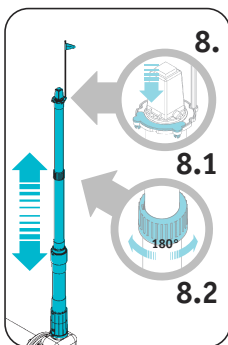
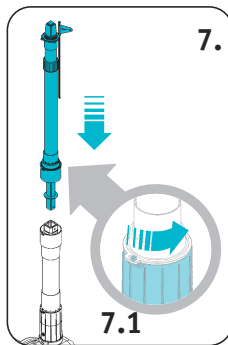
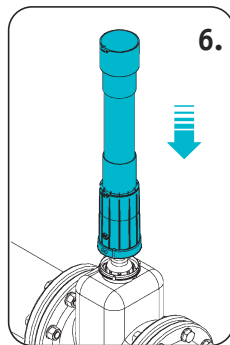
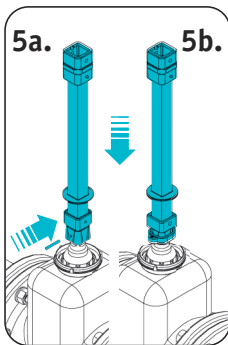
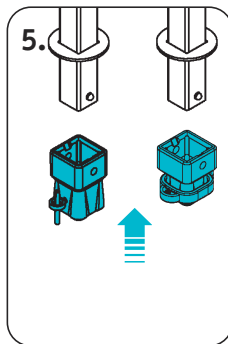
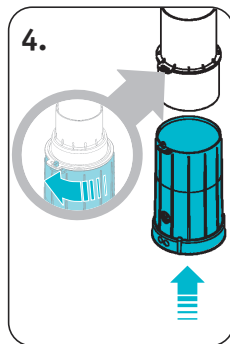
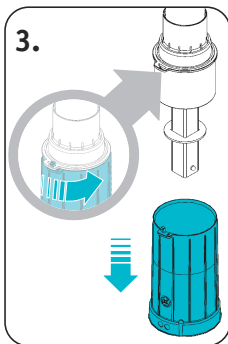
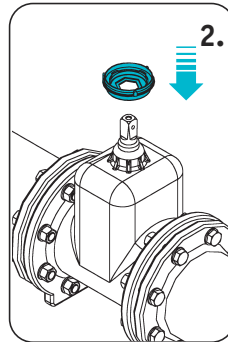
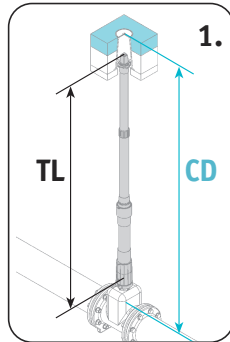

Assembling steps

1. Match total length of spindle extension (TL) with required cover depth (CD) and verify nominal valve size.
2. Mount matching dirt disk on valve.
 - 2.1 Open cap of KIT-Coupling-Module and remove coupling rod. Slip centring cap down.
3. Open locking system between bell tube and protective tube by turning it. Remove bell tube. Pull spindle extension rod about 10,0 cm out of protective tube.
4. Attach and lock bell tube to coupling module tube.
5. Attach coupling socket or Duplex-Coupling socket to the rod and verify, that spring connection pieces successfully snapped into the coupling socket's designated bore holes.
 - 5a. **Installation: Coupling socket**
(If necessary remove the valve's operating element first.)
Mount telescopic spindle extension rod with coupling socket on valve spindle, aligning bore holes of coupling socket and valve spindle. Use bolt to connect valve spindle and coupling socket.
 - 5b. **Installation: Duplex-Coupling socket**
(If necessary remove the valve's operating element first.)
Double-handedly mount telescopic spindle extension rod with Duplex-Coupling socket on valve spindle, aligning bolts of spring system and valve spindle, snapping bolts into place. Check for tight fit.
6. Bell tube first, thread protective tubing over coupling rod onto the top of the valve. Connect bell tube to dirt disk, by aligning lobes and latching them audibly. If necessary mount additional coupling modules via spring connection pieces and bell tube locking mechanisms in the same manner on top the first module.
 7. Mount telescope on top the coupling modules and plug spring connection piece into the designated coupling socket. Check for tight-fit.
 - 7.1 Lock the telescope's protective tube with the coupling module's tube.
8. Adjust telescope manually to the required length and extend marking flag
 - 8.1 If necessary attach marking-clip to the operating head.
 - 8.2 By turning the locking ring (max. 180°) an unintentional drop of the telescope can be prevented without loss of telescopic benefits.
9. Align telescopic spindle extension axial to the valve spindle and backfill with appropriate filling material (preferably compactable soil)
 10. During installation of the surface box, be sure to leave sufficient space for the operating element.