



# KETTLER

## INSTALLATION INSTRUCTIONS

OPERATING ACCESSORIES

### EBG

### fixed

**Tools required:**  
Hammer,  
drift punch Ø 3.5 mm

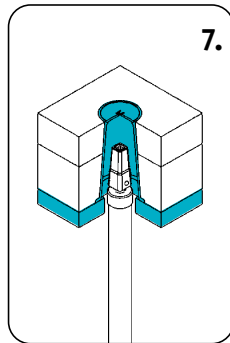
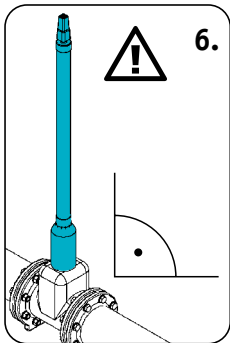
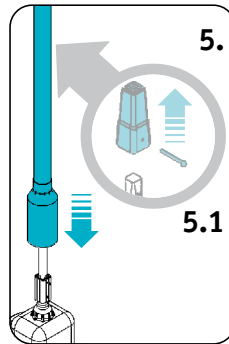
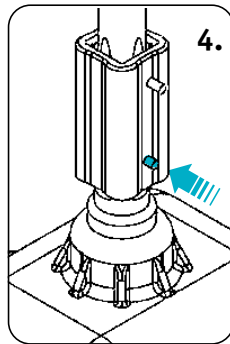
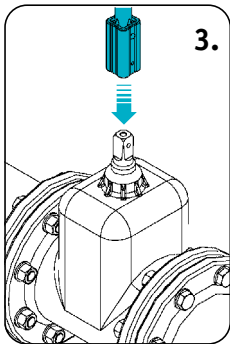
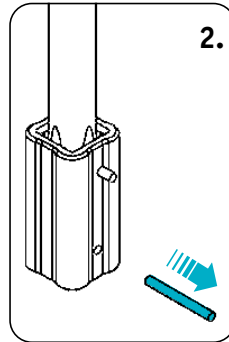
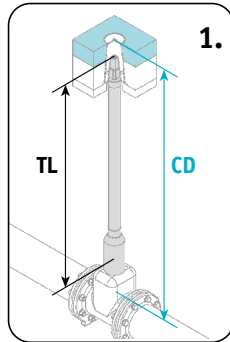

#### Assembling steps

1. Match total length (TL) of spindle extension with required cover depth (CD) and verify nominal valve size.
2. Remove and store bolt from coupling socket.
3. Mount spindle extension rod with coupling socket on valve spindle, aligning bore holes of coupling socket and valve spindle. (If necessary remove the valve's operating element first.)
4. Connect coupling socket and valve spindle by use of the stored bolt.
5. Bell tube first, thread protective tubing over spindle extension rod onto the top of the valve.
  - 5.1 If necessary remove operating element by removal of its rivet first and store it. After assembly of protective tubing, re-attach operating element on top the spindle extension
6.  Align spindle extension axially to the valve spindle and backfill with appropriate filling material (preferably compactable soil)
7. During installation of the surface box, be sure to leave sufficient space for the operating element.