

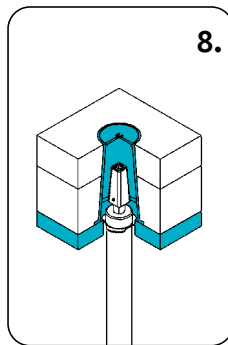
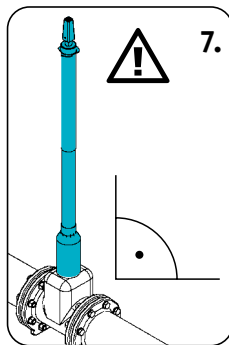
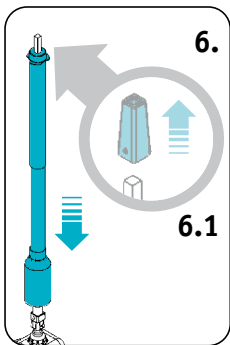
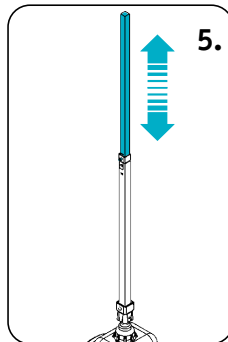
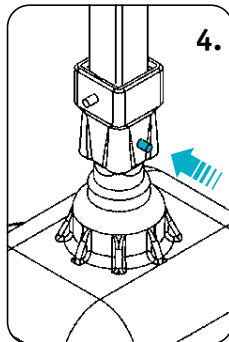
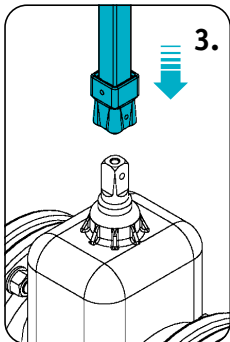
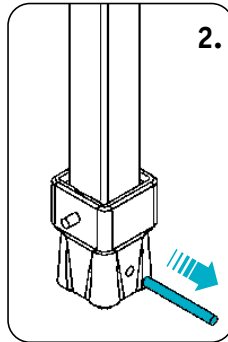
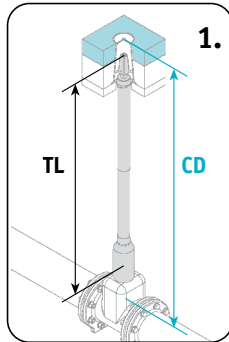

EBG

adjustable

Tools required:

Hammer,
drift punch Ø 3.5 mm,
hex key 4.0 mm

Assembling steps

1. Match total length of spindle extension (TL) with required cover depth (CD) and verify nominal valve size.
2. Remove and store bolt from coupling socket.
3. Mount spindle extension rod with coupling socket on valve spindle, aligning bore holes of coupling socket and valve spindle. (If necessary remove the valve's operating element first.)
4. Connect coupling socket and valve spindle by use of the stored bolt.
5. Loosen grub screw of the adjustment sleeve and adjust the extension spindle to the required cover depth. Tighten the grub screw.
6. Bell tube first, thread protective tubing over spindle extension rod onto the top of the valve.
 - 6.1 If necessary remove operating element by use of its grub screw first and store it. After assembly of protective tubing, re-attach operating element on top the spindle extension.
7. Align spindle extension axially to the valve spindle and backfill with appropriate filling material (preferably compactable soil) 
8. During installation of the surface box, be sure to leave sufficient space for the operating element.